

DEPARTMENT OF TRANSPORTATION
DIVISION OF HIGHWAYS
PROPOSED SUBDIVISION ROAD
CONSTRUCTION STANDARDS CERTIFICATION

APPROVED *H. L. Linder*
DISTRICT ENGINEER

DATE 10-27-87

NORTH CAROLINA - FORSYTH COUNTY

FINAL SUBDIVISION PLAT APPROVAL

This is to certify that this plat meets the recording requirements of the Subdivision Regulations for Winston-Salem/Forsyth County and, if applicable, that a certificate of approval has been issued by the Division of Highways pursuant to Article 7, Chapter 138 of the General Statutes, State of North Carolina.

This the 2nd day of February 1988

Ronald B. Linder
DIRECTOR OF PLANNING

I, LARRY L. CALLAHAN, certify that this map was drawn from (an actual survey made by me) Book 1604, Page 777, etc.; that the error of closure as calculated by latitudes and departures is 1:10,000+; that this map was prepared in accordance with G. S. 47-39 as amended. Witness my hand and seal this 30th day of SEPT. A.D. 19 87

(Surveyor's Seal) *Larry L. Callahan*
SURVEYOR

NORTH CAROLINA - FORSYTH COUNTY

I, PEGGY C. STOUT, Register of Deeds Notary Public or Clerk of Superior Court of Forsyth County N. C. do certify that LARRY L. CALLAHAN, NAME OF ENGINEER OR SURVEYOR, personally appeared before me this day and acknowledged the due execution of the foregoing certificate. Witness my hand and notarial seal this 30th day of SEPT. 19 87

(Seal) *Peggy C. Stout*
SIGNATURE AND TITLE

My commission expires 07-16-91

NORTH CAROLINA - FORSYTH COUNTY

The foregoing certificate was certified by *Peggy C. Stout*
NP Forsyth Co., NC
AND OFFICIAL TITLE OF THE OFFICER SIGNING

is certified by *K.K. Pierce*
DEPUTY ASSISTANT

Filed for registration at 3:34 p.m. Feb. 2, 1988 and recorded in Plat Book Page 129

L. E. Spass, Register of Deeds

Filing Fee \$99.00 Paid \$200.00

K.K. Pierce
DEPUTY - ASSISTANT

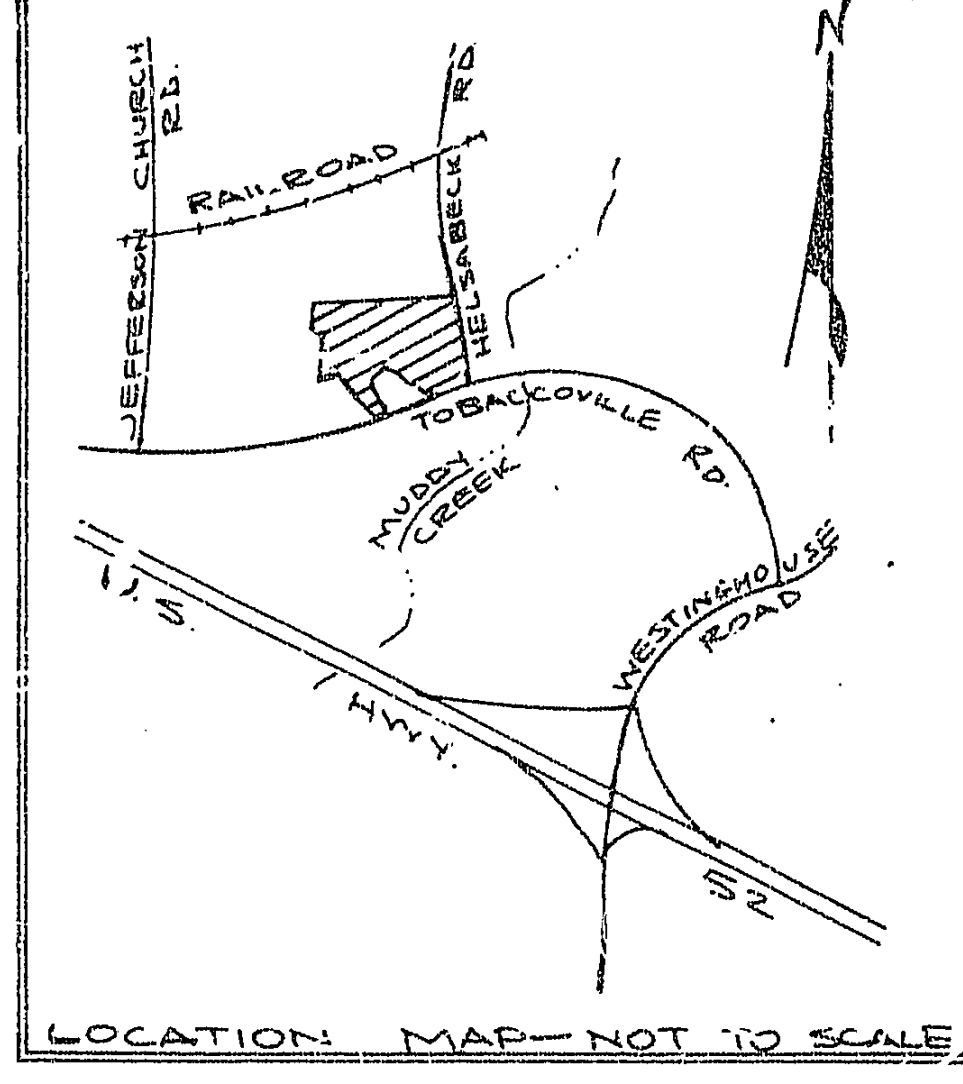
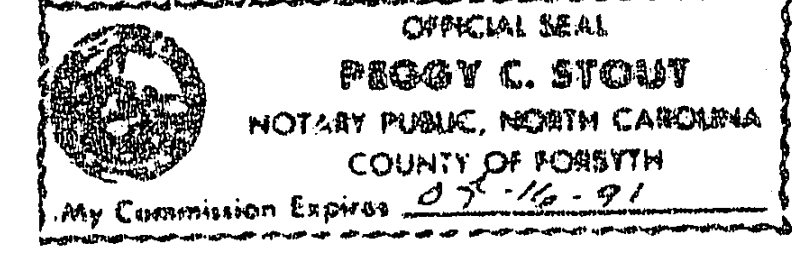

JOHN E. WRIGHT
D.B. 1293 PG. 1775
D.B. 1294 PG. 1156



#129

- LIFT STATION REQUIRED
- LIFT STATION MAY BE REQUIRED

WESTING TRACE
AREA: 17.601 AC. ±
BETHANIA TOWNSHIP FORSYTH COUNTY
NORTH CAROLINA

TAX LOT 309A AND PART OF TAX LOT 309B BLOCK 4972

SEPTEMBER 30 1987

SCALE: 1" = 100'
0 50 100 200 300 400

OWNER AND DEVELOPER
HOMER G. CARTER
8860 HELSABECK ROAD
RURAL HALL, N. C. 27045

HUBBARD REALTY OF W-S, INC.
285 S. STRATFORD RD.
WINSTON-SALEM, N. C. 27103

LARRY L. CALLAHAN SURVEYING CO., INC.
935 EAST MOUNTAIN ST., SUITE 1
KERNERSVILLE, N. C. 27284

Note: This plat is subject to any Easements, Agreements, or Rights-of-Way of record prior to date of this plat, which was not visible at the time of my inspection.

CENTERLINE CURVE DATA				
NO.	DELTA	RADIUS	TANGENT	ARC
①	44°37'44"	377.66	155.00	294.17
②	18°18'07"	620.78	100.00	198.30
③	25°41'48"	438.44	100.00	196.64